



[Knowledgebase](#) > [Software](#) > [Adobe Creative Cloud migration](#)

# Adobe Creative Cloud migration

Brian - 2025-11-25 - [Software](#)

OIT has recently begun providing Adobe products to certain faculty and staff. Because of this, all of the COM Adobe Creative Cloud licenses have moved to OIT's management. All COM Adobe Creative Cloud users will need to sign out of Creative Cloud and back in using the following process.

1. Open the Creative Cloud Desktop application.
2. Click on the user profile icon in the upper right corner and click Sign out and then Continue when prompted, as shown below:

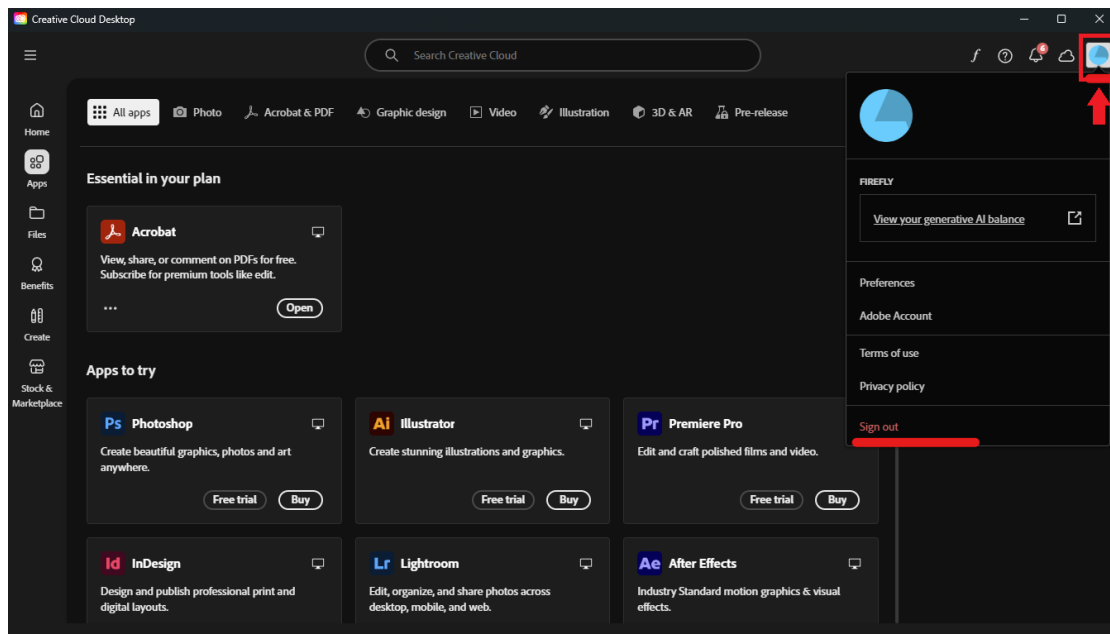

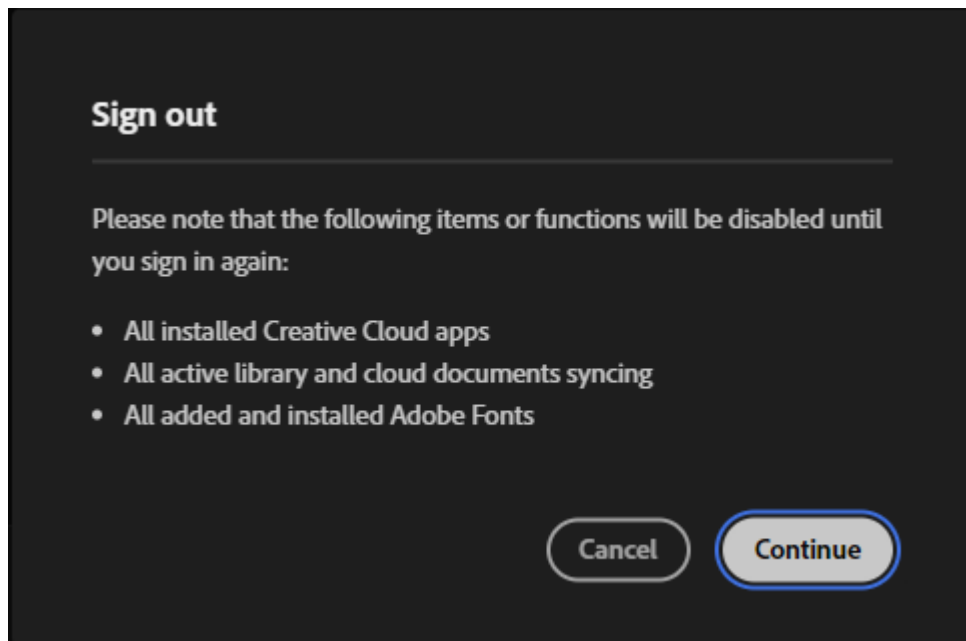

1. After signing out, you will be prompted to sign in again.
2. Enter your full FAU email for example: name@health.fau.edu.

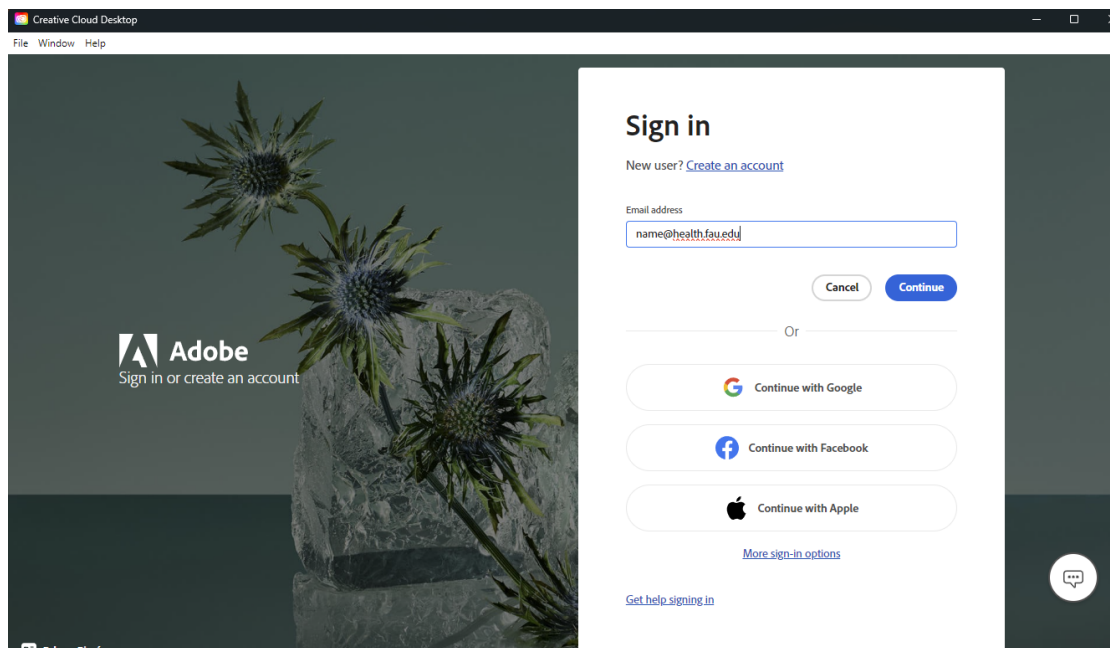

1. Choose Company or School Account if prompted.

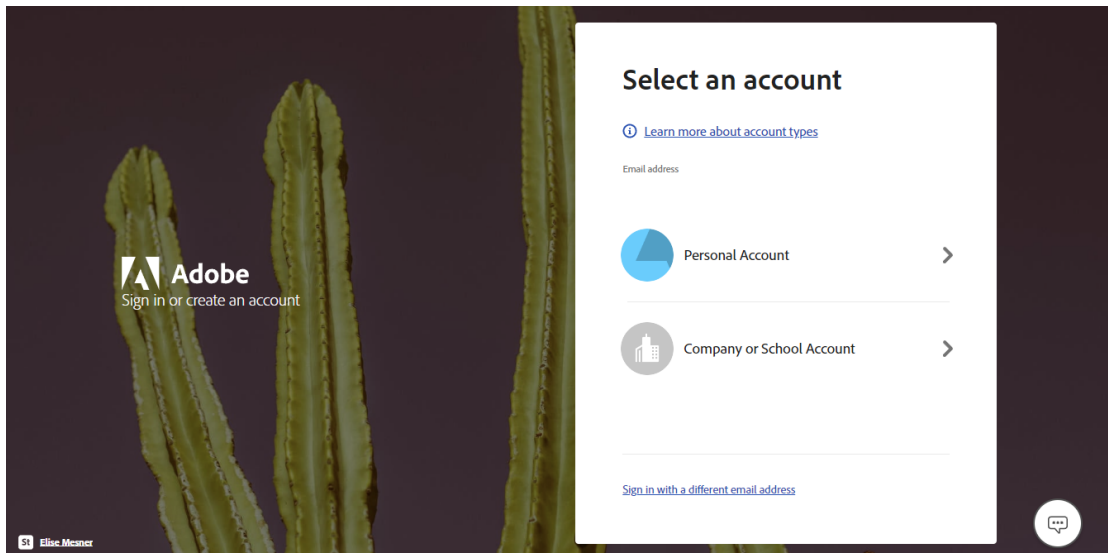

1. Enter your FAU ID and password in the standard SSO page.
2. Select FAU-OIT if prompted to use the OIT license.

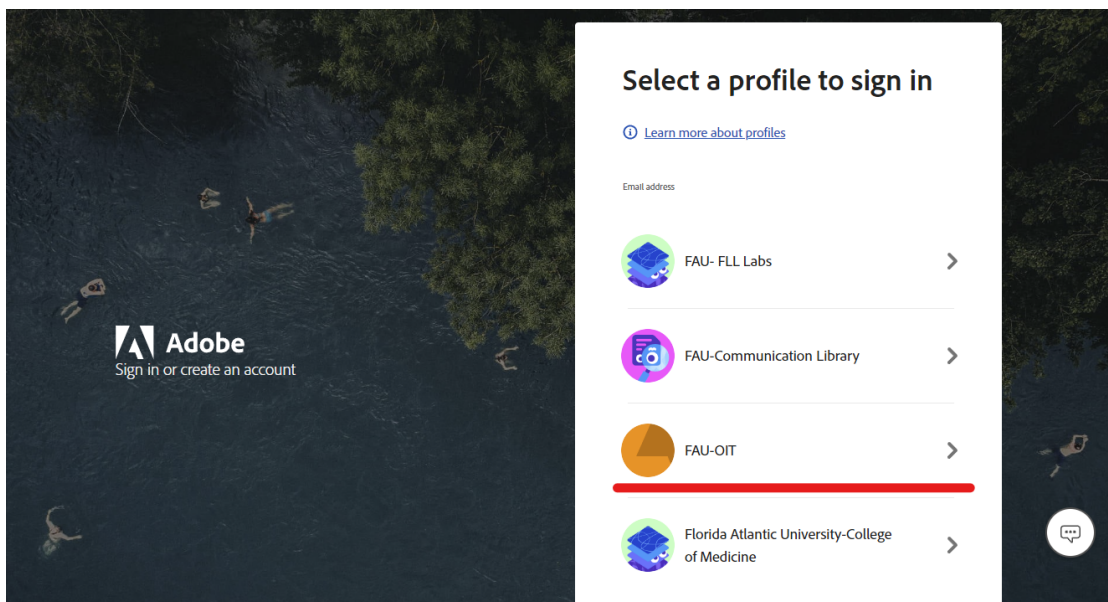

Once signed in, you will be using the new OIT license and you should have full access to all Creative Cloud products.

If you have any issues, please email us at [comhelpdesk@health.fau.edu](mailto:comhelpdesk@health.fau.edu).