



FLORIDA ATLANTIC UNIVERSITY

Charles E. Schmidt
College of Medicine

[Knowledgebase](#) > [iPad Support](#) > [M4 Erasing your iPad](#)

M4 Erasing your iPad

Brian - 2025-02-13 - [iPad Support](#)

Erase iPad

You can securely erase your personal information, content, and settings (such as privacy and network settings) from your iPad. When you erase your iPad, it's restored to factory settings. If you want to reset your iPad settings but keep your personal content, see [Reset iPad settings to their defaults](#).

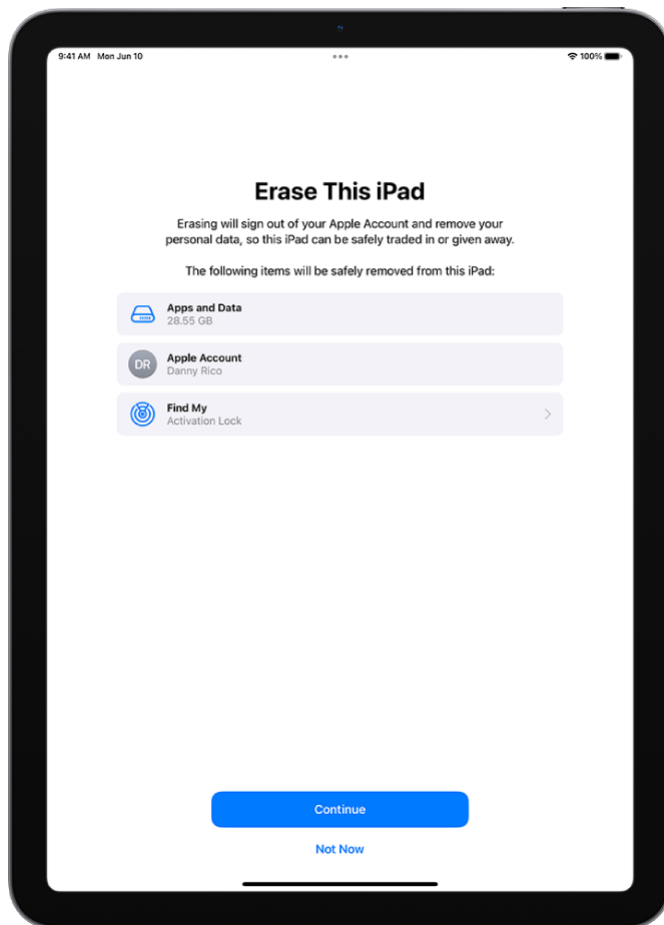

Before you begin

Back up your iPad so you can restore your data later on a different device.

Erase iPad using SettingsGo to Settings > General > Transfer or Reset iPad. Tap Erase All Content and Settings. If asked, enter your iPad passcode or Apple Account password. Tap Continue to confirm. If you have an eSIM, you can choose to erase your eSIM or keep it. If you erase your eSIM, you need to contact your carrier to reactivate your cellular plan.